

SKETCH CALCULATIONS

Perimeter

Area

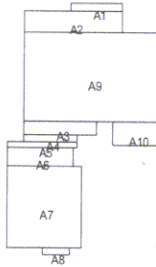

A1: 16.2 x 2.0 =	32.3
A2: 29.9 x 6.5 =	194.5
A3: 22.0 x 4.2 =	91.7
A4: 16.0 x 1.9 =	30.7
A5: 21.3 x 1.5 =	32.0
A6: 20.3 x 5.6 =	113.4
A7: 23.0 x 23.0 =	529.0
A8: 8.3 x 2.0 =	16.5
A9: 40.8 x 25.2 =	1025.3
A10: 13.6 x 7.0 =	95.1
Attached Garage	-545.5

First Floor

1615.0

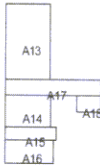

A13: 13.7 x 21.8 =	300.2
A14: 14.3 x 9.2 =	131.8
A15: 15.8 x 3.2 =	51.2
A16: 14.8 x 6.8 =	100.7
A17: 29.4 x 4.3 =	127.7
A18: 7.5 x 4.8 =	36.2

Second Floor

747.8

Total Living Area

2362.8



A19: 23.0 x 23.0 =	529.0
A20: 8.3 x 2.0 =	16.5

Attached Garage

545.5

Total Garage Area

545.5

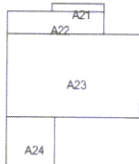

A21: 16.2 x 2.0 =	32.3
A22: 29.9 x 6.5 =	194.5
A23: 40.8 x 24.0 =	978.0
A24: 15.0 x 14.3 =	214.9

Basement FINISHED

1419.7

Total Basement Area

1419.7